

ATTACHMENT "A"

- Phase 1
- Phase 2
- Onsite Basin lot 51, Roadway lots 54 & 55 to remain under County of Maui ownership
- 3 County of Maui lots
- 3 Nā Hale O Maui lots
- 3 Hospital Foundation lots

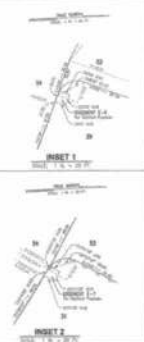

NOTES:

1. ALL DISTANCES AND BEARING CORRECTIONS MADE TO ADJUSTMENT SMOOTH TRIANGULATION DATA.
2. POINTS OF INTERSECTION, BEARINGS, AND DISTANCES ARE GIVEN IN FEET, UNLESS OTHERWISE NOTED TO BE IN MILES OR METERS.
3. POINTS SHOWN WITH (C) INDICATE CORNER NUMBER OR IDENTIFIER.
4. ALL DISTANCES SHOWN ARE UNLESS NOTED TO BE IN FEET, UNLESS OTHERWISE NOTED TO BE IN METERS.
5. ALL DISTANCES SHOWN ARE UNLESS NOTED TO BE IN FEET, UNLESS OTHERWISE NOTED TO BE IN METERS.
6. ALL DISTANCES SHOWN ARE UNLESS NOTED TO BE IN FEET, UNLESS OTHERWISE NOTED TO BE IN METERS.
7. ALL DISTANCES SHOWN ARE UNLESS NOTED TO BE IN FEET, UNLESS OTHERWISE NOTED TO BE IN METERS.

AREA OF EASEMENTS:

EASEMENT 0-1: THE GRANITE PAVEMENT, APPROXIMATE LOTS 16 TO 24, INCLUDING A 10-FOOT WIDE, 10-FOOT DEEP DRAINAGE CHANNEL, APPROXIMATE LOTS 16 TO 24 TO BE CONVEYED TO LOT 16 BY DEED.

EASEMENT 0-2: THE GRANITE PAVEMENT, APPROXIMATE LOTS 25 TO 33, INCLUDING A 10-FOOT WIDE, 10-FOOT DEEP DRAINAGE CHANNEL, APPROXIMATE LOTS 25 TO 33 TO BE CONVEYED TO LOT 25 BY DEED.

EASEMENT 0-3: THE GRANITE PAVEMENT, APPROXIMATE LOTS 34 TO 42, INCLUDING A 10-FOOT WIDE, 10-FOOT DEEP DRAINAGE CHANNEL, APPROXIMATE LOTS 34 TO 42 TO BE CONVEYED TO LOT 34 BY DEED.

EASEMENT 0-4: THE GRANITE PAVEMENT, APPROXIMATE LOTS 43 TO 50, INCLUDING A 10-FOOT WIDE, 10-FOOT DEEP DRAINAGE CHANNEL, APPROXIMATE LOTS 43 TO 50 TO BE CONVEYED TO LOT 43 BY DEED.

EASEMENT 0-5: THE GRANITE PAVEMENT, APPROXIMATE LOTS 51 TO 55, INCLUDING A 10-FOOT WIDE, 10-FOOT DEEP DRAINAGE CHANNEL, APPROXIMATE LOTS 51 TO 55 TO BE CONVEYED TO LOT 51 BY DEED.

THE FAIRWAYS AT MAUI LAHII  
 LANS DEVELOPER ON THE WESTERN SIDE OF SEVERAL SECTIONS --  
 KUALA TOHO DEVELOPMENT (FILE PLAN 2000) AND  
 SOUTH MAUI DEVELOPMENT (FILE PLAN 1990) AND  
 ON THE SOUTHWEST SIDE OF MAUI LAHII DEVELOPMENT  
 PHASE 1 (FILE PLAN 1990)

WITNESSED AND APPROVED BY THE BOARD OF SUPERVISORS  
 COUNTY OF MAUI  
 HON. JOHN A. WOOLACOTT, JR.  
 SUPERVISOR - SOUTH MAUI DISTRICT  
 HON. JOHN A. WOOLACOTT, JR.  
 SUPERVISOR - WESTERN MAUI DISTRICT

DESIGNED AND CONSTRUCTED BY:  
 1. SURVEY AND ENGINEERING FIRM, INC. 27, 28, 29 AND 30  
 2. SURVEY AND ENGINEERING FIRM, INC. 31

TOTAL AREA = 13.148 ACRES

This plan is a part of a larger project and is subject to the provisions of the Maui Planning Act, Chapter 160, Hawaii Revised Statutes, and the Maui Planning Rules, Chapter 160, Maui Administrative Code System. The applicant certifies that the information on this plan is true and correct and that the applicant is the owner of the property shown hereon. The applicant is responsible for the accuracy of the information shown hereon. The applicant is responsible for the accuracy of the information shown hereon.

MAUI PLANNING BOARD  
 HON. JOHN A. WOOLACOTT, JR., Chairman  
 HON. JOHN A. WOOLACOTT, JR., Vice Chairman  
 HON. JOHN A. WOOLACOTT, JR., Secretary